

Subject: FRONT BRAKES SQUEAK WHEN APPLYING BRAKES	Bulletin No: 04-001/08
	Last Issued: 1/16/2008

APPLICABLE MODEL(S)/VINS

2007-2008 CX-7

2007-2008 CX-9

DESCRIPTION

After parking in cold temperatures accompanied by a humid climate, some vehicles may exhibit a squeak from the front brakes during initial braking. This noise is caused due to deterioration of grease between the front disc pads, shims and the brake caliper.

Customers having this concern should have their vehicle repaired using the following repair procedure.

REPAIR PROCEDURE

When you encounter a customer complaint, replace the guide plates (A) with service parts, then apply white grease (provided with guide plates) to the location indicated on the caliper (B) and mounting support (C) according to the following procedure.

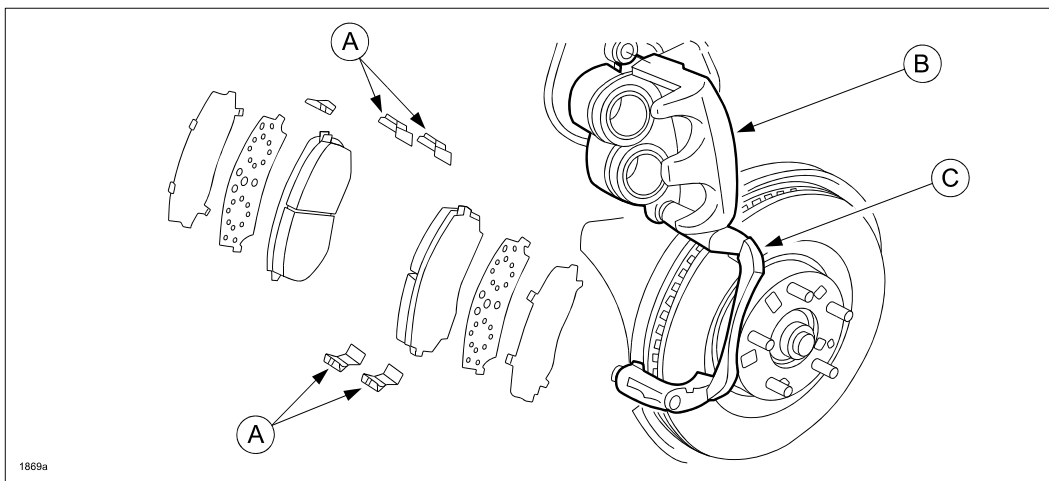

1. Verify customer concern.
2. Remove caliper and disc pads. Refer to appropriate Workshop Manual section 04-11 DICSC PAD (FRONT) REPLACEMENT.

NOTE:

- Note location of disc pads for installation as the existing ones will be used.

3. Clean the guide plate seating area (D) using brake parts cleaner or equivalent.

4. Peel off the backing sheet of the double-sided tape on the guide plate (F), then install the guide plate in the mounting support (E).

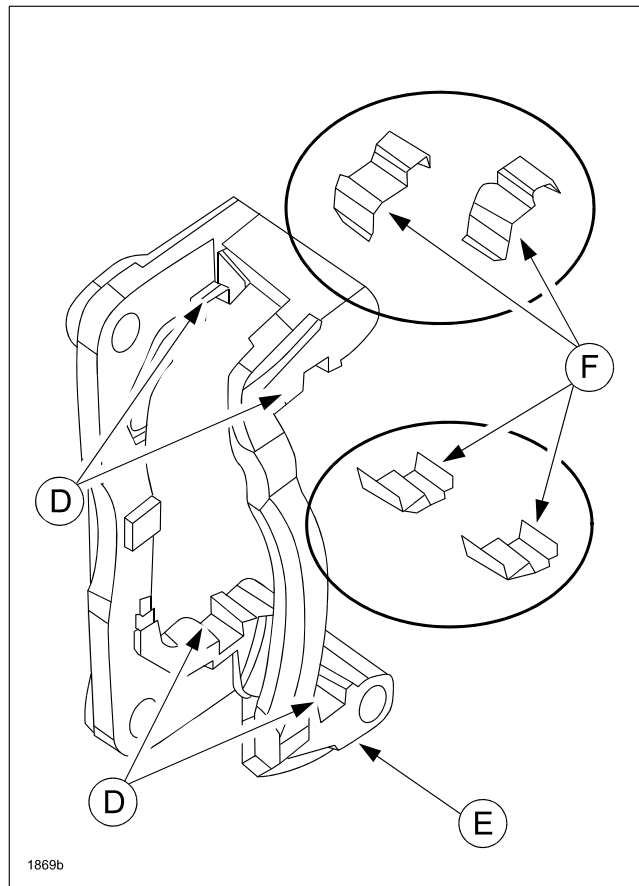

NOTE:

- DO NOT apply any grease on the guide plate seating area of the mounting support.
- If the double-sided tape of the new guide plate is damaged during installation, be sure to discard the guide plate and use a new one.

5. Clean the ends of the caliper pistons (G) and the caliper body (H, I) using brake parts cleaner or equivalent. Remove all shims from the disc pads and clean off black grease.

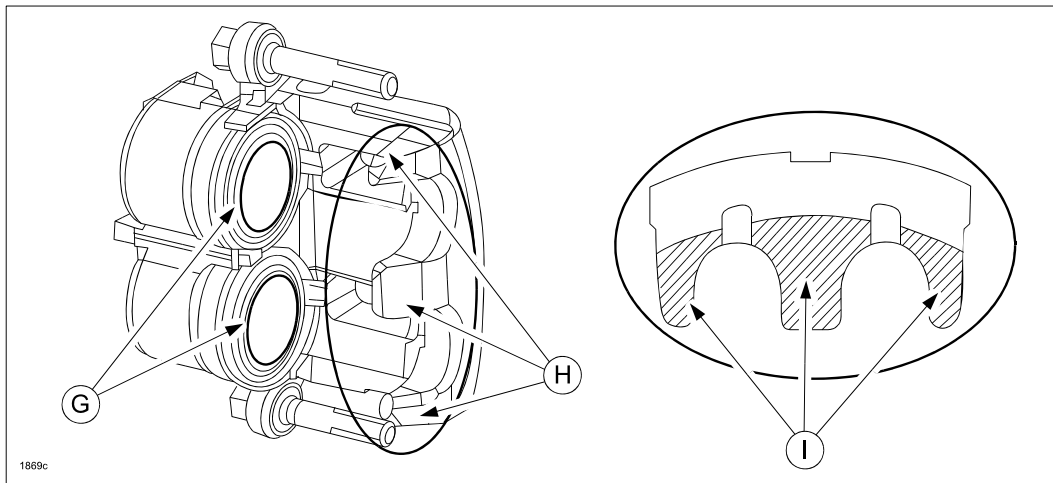

NOTE:

- Note location of shims for installation.

6. Lightly and evenly apply white grease (provided with guide plates) to the following:
 - End of brake caliper pistons (G).
 - Brake caliper body (I).
 - Pad-to-shim surface and between the shims (all shims).

CAUTION:

- Use care not to get any grease on the disc pad-to-rotor surface or rotor. If grease comes in contact with the disc pad-to-rotor surface or rotor, clean grease using brake parts cleaner.

7. Install original shims to disc pads in same location as when removed.
8. Install disc pads and caliper. Refer to appropriate Workshop Manual section 04-11 DICSC PAD (FRONT) REPLACEMENT.
9. Verify repair.

PART(S) INFORMATION

Part Number	Description	Qty.	Notes
L2Y7-33-29Z	Guide Plate & White Grease	1	White Grease (3 pcs.) Guide Plate (8 pcs.)

WARRANTY INFORMATION

NOTE:

- This warranty information applies only to verified customer complaints on vehicles eligible for warranty repair. Refer to the Warranty Wizard for warranty term information.
- Additional diagnostic time cannot be claimed for this repair.
- Coverage period is 12 months or 12,000 miles (whichever occurs first).

Warranty Type	A
Symptom Code	35
Damage Code	9E
Part Number Main Cause	L2Y7-33-29Z
Quantity	1
Operation Number / Labor Hours:	XXC57XRX / 0.5 Hrs.